

KINGSETTLE STUD

at CHOLDERTON ESTATE

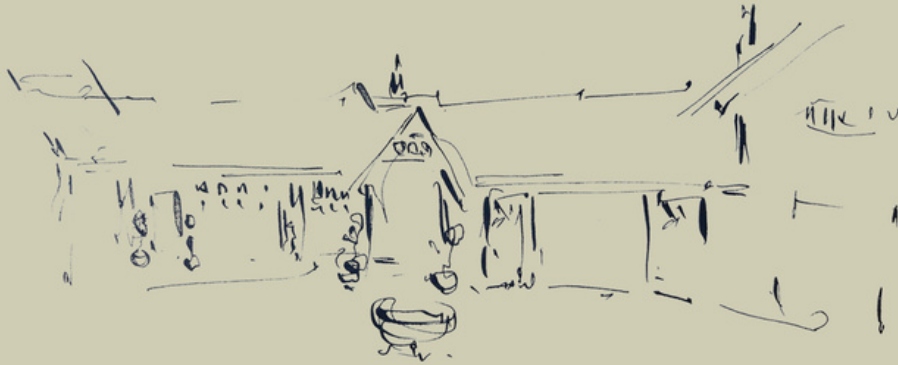

Accommodation at Kingsettle Stud

The Coach House (£160 per night, min 2 night stay)

Sleeps 4 across 2 Bedrooms (1 x King and 1 x twin) with kitchenette and bathroom

Lapwing Hut (£140 per night, min 2 night stay)

Sleeps 2 (King size bed) with kitchenette and bathroom

Bustard Hut (£160 per night, min 2 night stay)

Sleeps 4 (1 x King size bed and a bunk bed) with kitchenette and bathroom

Kingsettle Stud House (£1000 per night, min 3 night stay)

Sleeps 8 across 4 Bedrooms: 1x Superking, 2 x King, 1 x twin. Additional sofa bed.

Two spacious bathrooms upstairs plus downstairs loo. Large kitchen, laundry facilities, snug and large dining room/entertaining room with dining table to seat 10-12.

The Coach House, Lapwing Hut and Bustard Hut must be used over your wedding weekend by you or your guests. Accommodation shall be blocked as unavailable on the website so that only you or your guests may reserve it (e-mail us to do so).

Local Hotels and BnBs

Very Nearby

The Old Rectory on Airbnb link [here](#)

Gray Manor Hotel <http://www.graymanorhotel.co.uk>

Holiday Inn Salisbury <http://hisalisbury-stonehenge.co.uk>

Larger and Luxurious Hotels

The Grosvenor www.thegrosvenorstockbridge.com

Norton Park <https://www.qhotels.co.uk/our-locations/norton-park/> Essebourne Manor <http://www.esseborne-manor.co.uk>

Henge Estate www.hengeestate.com

Small and Characterful

The Greyhound <https://thegreyhoundonhetest.co.uk/>

The Hawk Inn <http://www.hawkinnamport.co.uk>

The Peat Spade <http://www.peatspadeinn.co.uk>

Bourne Valley <http://www.bournevalleyinn.com>

Manor Farm BnB <http://www.manorfm.co.uk>

There are also numerous local accommodation options on AirBnB including a couple of larger houses in the village.

The field adjacent to the venue can be used for bell-tent/glamping villages. Guests may camp in the field with their own equipment at our discretion.