

KINGSETTLE STUD

at CHOLDERTON ESTATE

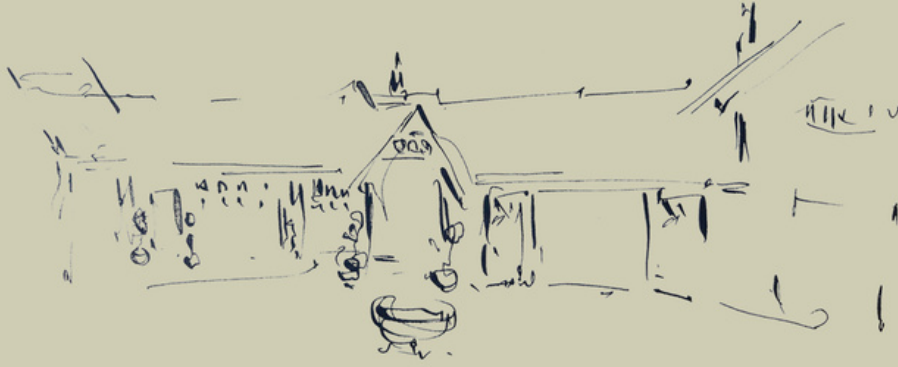

Wedding Prices 2025/2026

Kingsettle Stud is a family-owned venue holding a limited number of weddings annually from May-September. Each wedding is unique; we don't do 'packages', won't charge corkage, and have an 'Open Supplier Policy'.

Dry Hire: £6000 (+ £500 damage deposit)

What's included?

- Exclusive use with access from 10am the day before for set-up, until 12 noon the day after your event for clean-up.
- Dance-floor and Glitter ball
- Decorative items and furniture *incl.* cake-table, firepit and outdoor seating
- Use of our Bar in the Harness Room including drinks fridge and ice freezer
- Field for glamping at no extra charge
- Luxury 3+1 toilet block (sufficient for 150 people over 12 hour period).
- Fifteen 2'6 x 6' trestle tables

What is NOT included? You'll need to source a Caterer (incl. table linen and glassware), a Florist/Venue stylist and Entertainment. We have chairs and hay bales that you can hire at competitive rates. We also have a little black book of suppliers that we love, should you need inspiration.

Our max. Capacity is 150.

Details of on-site accommodation can be found in our 'Accommodation List'

A non-refundable £1000 deposit secures your chosen date. The final balance is payable 6 months prior to your wedding.